

## Location Map



design by - [www.b-creative-mantras.com](http://www.b-creative-mantras.com) - 9999942483



APEXndia Pvt. Ltd.

Sector - 3, Vaishali, Ghaziabad (U.P) - 201012  
Mob. No. : +91-8010654321



*Apex Athena*  
*Defined on Mordern Living*

*Over the years, Noida has emerged as one of the fastest growing planned, integrated modern city with well-developed infrastructure like schools, colleges, hospitals, shopping malls, multiplexes and city parks. Noida is well connected to Delhi-NCR through a wide network of national express highways, Metro Rails, and ultra modern DND flyway. All these makes Noida as one of the most sought after destinations and a prestigious address. Amidst all this Sector-75 is just the perfect choice for your dream home. Well located, well planned and well connected.*

*The project Apex Athena is promoted by M/S. APEX Dream Homes Pvt. Ltd. under the banner of 'APEX GROUP', a well known name in the development and construction of real estate. We make dreams come true by fulfilling lifetime aspirations and ambitions.*



*Apex Athena  
Transforming Grace & Beauty*

You will be mesmerized by the elegance with which each home has been constructed, facing a huge green belt with keeping in mind the modern landscaping designs that suites the lifestyle of today's trend and more to compliment it is the great location in the heart of Noida city. These 2/3/4 bedroom apartments are the project one has dreamt to be lived in and we provide our best amenities to our esteemed customers for better tomorrow with affordable prices. The homes here are not just artistic but are equally realistic and practical with finest design, aesthetic values that matches international standards. You will find each facility made available keeping in mind the modern day needs of the affluent class. The most essential that we understood the importance of having space in the place we dwell, space that librates, space that sets you comfortable and free, that leads you to grow and have freedom to creative imagination to soar.



## *Apex Athena*

*Transforming Space into Grace & Beauty*

*Space in the place we dwell, space that liberates, space that sets you comfortable and free, that leads you to grow and have freedom to creative imagination to soar.*







## *Amenities*



### *Apex Athena The Most Promising Address*

*Strategically located in Sector - 75*

*Three side open plot*

*5 minutes distance from Center City Metro Station*

*4 Km distance from Taj Expressway and 6 Km distance from DND Expressway*

*Close to the corporate and commercial districts of Noida*

*En route to F1 Racing Track*

*Approx. 80% open area with central park, roads*

*Green surroundings and landscapes*

*Vastu and eco - friendly*

*24X7 security surveillance*

*Designed for natural ventilation & light Power backup facility*

*Club house with indoor games and gymnasium Swimming pool*



# Specifications

## Structure

Structure	- Earthquake resistant RCC frame structure
External Finish	- External quality paint system, stone cladding, glazing, aluminium louvers, wooden pergolas at roof level

## Dining & Passage

Floor	- Vetrified tiles
Walls & Ceiling	- Plastered surface and painted with pleasing shade of OBD

## Drawing Room

Floor	- Vetrified tiles
Walls & Ceiling	- Plastered surface and painted with pleasing shade of OBD

## Master Bedroom

Floor	- Laminated wooden flooring
Walls & Ceiling	- Plastered surface and painted with pleasing shade of OBD
Toilet	- Branded single lever CP fittings, premium sanitary wares and ceramic tiles dado

## Other Bedroom

Floor	- Laminated wooden flooring
Walls & Ceiling	- Plastered surface and painted with pleasing shade of OBD
Toilet	- Branded single lever CP fittings, premium sanitary wares and ceramic tiles dado

## Kitchen

Floor	- Full body vetrified tiles
Walls & Ceiling	- Designer ceramic tiles above the centre level, rest plastered surface and painted with pleasing shades of OBD. Ceiling painted with OBD
Others	- Granite counter top

## Balconies

Floor	- Anti skid ceramic tiles
Ceiling	- As per exterior

## Door & Windows

Interiors frames	- Designer Flush / Modular wooden doors with painted finish & SS finish accessories on wooden inside the apartments
External Doors & Windows	- UPVC / aluminum with insulated glass on the external side for energy saving and noise reduction

## Security

State-of-the-art Gadgets	- 24x7 security with hi-end equipments, CCTV surveillance in the entire complex connected to security control room / management office
Entry & Exit Gates	- Boom barriers to block vehicular access through a controlled point

## Facilities

Club	- Swimming pool, well equipped gymnasium, sauna, steam, Jacuzzi, kids play area, indoor & outdoor games, meditation room and multi-purpose hall
Lifts	- Latest high - speed lifts with stainless steel finish and equipped with intercom & camera connected to the security room
Others	- 100% power back-up, wi-fi enabled complex, ample parking space, beautifully landscaped DTH provision for satellite TV

## Disclaimer

- This floor plan booklet is purely conceptual and not a legal offering.

- The products and designs described here are part of the phased development over a period of time. All building plans, floor plans, site plan, elevations & specifications are tentative and subject to variations & modifications by the company or the competent authorities sanctioning plans.

- 1 sq. m = 10.764 sq.ft.



*Site  
Layout  
Plan*

1. ENTRY
2. BUILDING BLOCKS
3. COMMERCIAL
4. CLUB
5. PLAZA
6. LAWN
7. SWIMMING POOL
8. JOGGING TRACK
9. ROAD
10. WATER BODIES
11. RAMPS
12. BASKETBALL COURT
13. BADMINTON
14. AMPHITHEATRE
15. TEMPLE
16. TENNIS
17. GAZEBO
18. KID'S POOL
19. PAVILION
20. THEME GARDEN



APEX  
**Athena**

## Floor Plans

### Unit Type - 2



AREA - 1295 sq.ft.

2 bedroom + Study + living room / dining + kitchen + family lounge +  
2 toilets + 5 balconies

## Unit Type - 3A



AREA - 1732 sq. ft.

3 bedroom + living room / dining + kitchen + family lounge +  
3 toilets + 5 balconies

## Unit Type - 3B

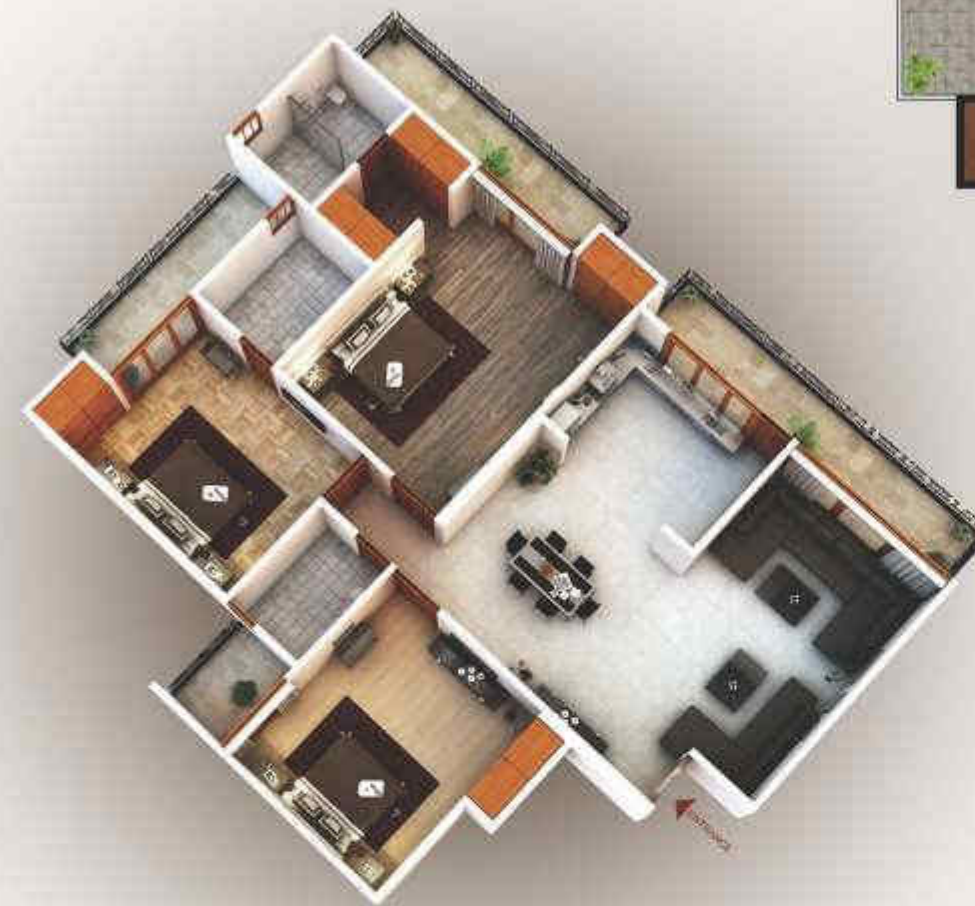

AREA - 1895 sq.ft.

3 bedroom + living room / dining + kitchen + family lounge +  
3 toilets + 4 balconies

## Unit Type - 3C



AREA - 2099 sq.ft.

3 bedroom + Servant + living room / dinning + kitchen + family lounge + 4 toilets + 4 balconies



## Unit Type - 4 +



AREA - 2725 sq.ft.

4 bedroom + Servant + living room / dinning + kitchen + family lounge + 5 toilets + 5 balconies



Apex  
Previous Projects



**Apex Acacia Valley**  
Sec - 3, Vaishali, Ghaziabad



**Shanti Sehkar Awas Apartments**  
Abhay Khand - 3 Indirapuram, Ghaziabad  
Consisting 48 Units



**Anuradha Sehkar Awas Apartments**  
Plot 1, Sector - 3 Indirapuram, Ghaziabad  
Consisting 80 Units



**Vardan Sehkar Awas Apartments**  
Abhay Khand - 3 Indirapuram, Ghaziabad  
Consisting 88 Units



**Kala Vihar Apartments**  
Mayur Vihar Phase - I, New Delhi  
Consisting 140 Units



**APEX Green Valley**  
Sec - 9, Vaishali, Ghaziabad  
Consisting 123 Nos. of Supper HIG Appts.



**Media Times Sehkar Awas Apartments**  
Abhay Khand - 4 Indirapuram, Ghaziabad  
Consisting 128 Units



**Nanda Devi Apartments**  
Plot - 19, Sector - 10, Pappan Kala,  
Dwarka, New Delhi, Consisting 75 Units



**New Adarsh Apartments**  
Plot - 22, Sector - 10, Pappan Kala,  
Dwarka, New Delhi, Consisting 79 Units



**Arur Co-operative Apartments**  
Plot 10, Mayur Vihar Phase 1, Delhi  
Consisting 91 Units



**Khattar Co-operative Apartments**  
Consisting 100 units



**DSIDC Co-operative Apartments**  
Plot 23, Sec - 9, Rohini Delhi  
Consisting 135 units